

Northern line extension

ACTIVITY NOTIFICATION

20 April 2015

Nine Elms – Planned Works April 2015

The Northern line extension (NLE) works near you are progressing well and we would like to update you on the activities happening on site for the next four weeks.

We have commenced preparing the ground for the excavation of the future station. This includes breaking the existing concrete and removal of obstructions. The chimney and boiler house situated beside the car park will be demolished and we are also working on the demolition of the inside of Covent House. The construction of the site accommodation will also commence in this period.

There will be vehicle movements (lorries) to remove excavated material and delivery of construction material for the main working areas shown in green on the diagram below. Vehicles serving the site will use a one way system entering and exiting from Wandsworth Road. For the safety of pedestrians, the public footpath will change around the end of April as shown by the green dotted line on the diagram below.

Our core working hours are **Monday to Friday 0800 to 1800** and on **Saturday from 0800 to 1300**

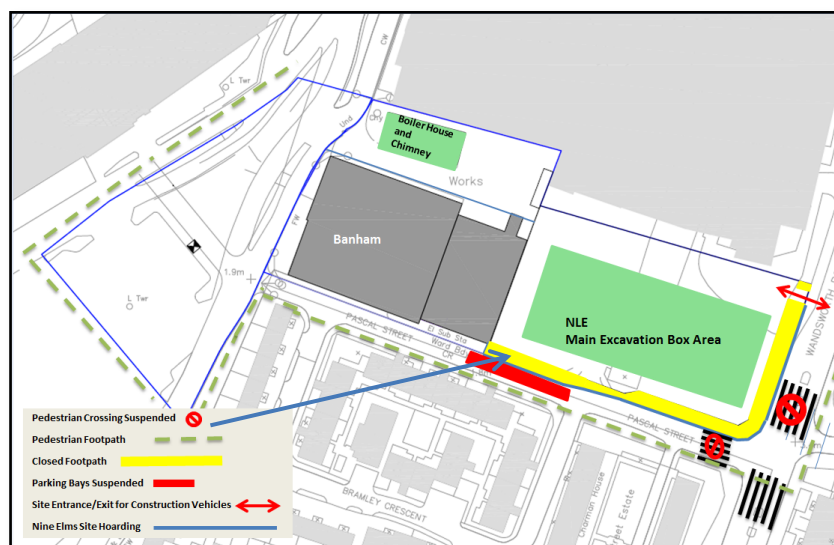

We will endeavour to minimise disturbance and will manage the work in accordance with the Code of Construction Practice, including the control of noise, vibration and dust using best practicable means. Traffic marshals will be on site to help with traffic and vehicle access and signage will be installed to manage the changes mentioned above.

**If you have any concerns or queries, please contact us at nle@tfl.gov.uk
or call our 24/7 helpdesk on 0343 222 2424**

nle@tfl.gov.uk
0343 222 2424